

# PBRODI.TR - Trailing Edge Push Button Rotary Dimmer and Switch

## Datasheet



### Product codes

**Unit:**  
PBRODI

**Dim Type:**  
TR

**Load:**  
400W

### Dimensions (mm)

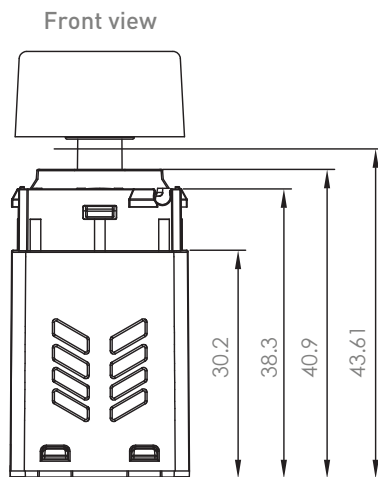

Top view

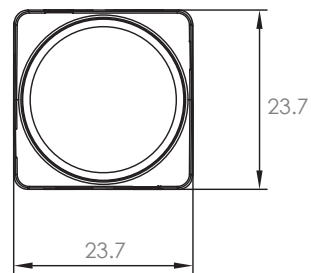

### Electrical

**Input Voltage:**  
220-240 V

**Max Lamp Load:**  
400W @1 gang  
Derate for multi-gang  
applications

**Rated Power:**  
400W

**Mounting centres:**  
84mm Australian  
pattern plate

**Frequency:**  
50 Hz

**Min Lamp Load:**  
5W

## Operational

**Dimming Technology:**

Trailing edge phase control

**Operational Temp:**

0-40°C

Suitable for indoor use only

**Control:**

Push Button - on/off  
Rotary Control - dimming

**Safety Standard:**

AS/NZS3100, AS/NZS3133,  
IEC60669-2-1

No user serviceable  
parts inside

**Warranty:**

5 years

**EMC:**

AS/NZ CISPR15,  
IEC60669-2-1 (26.1, 26.2),  
IEC61000-3-2 (Except when used in  
conjunction with Electrical loads)

## Load compatibility



Dimmable LED lighting



Incandescent lighting  
240V halogen lamps



Low voltage halogen lighting  
with electronic transformers

## Features

- Modular dimming mechanism.
- Two-wire phase control wallplate dimmer.
- Soft-start for lamp and driver life.
- Provide optimized dimming of LED based lamps and drivers.
- Compatibility with incandescent lamps, 240V halogen lamps and low voltage halogen lamps with dimmable electronic transformers.
- Wall or architrave mounting options.
- Wide range of plate styles and color variants available.
- Suitable for new installations or retro-fit applications.
- Inbuilt Over-Current and Over-Temperature protection.
- Full short circuit protection.
- Immune to high frequency (ripple) signal injection on mains supply.
- Complies with Australian and International EMC Standards.

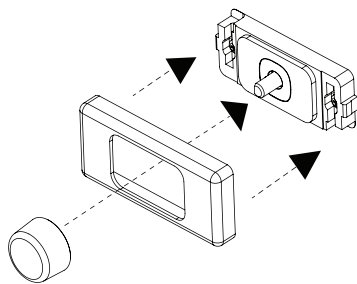
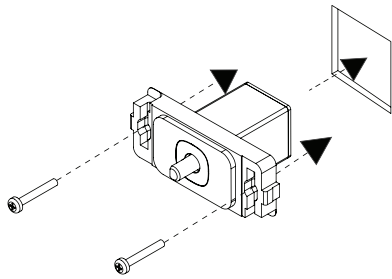
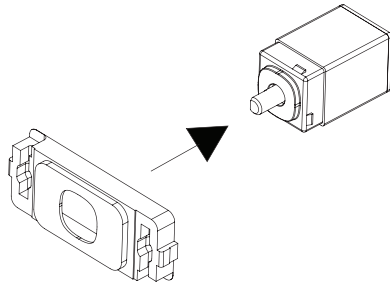
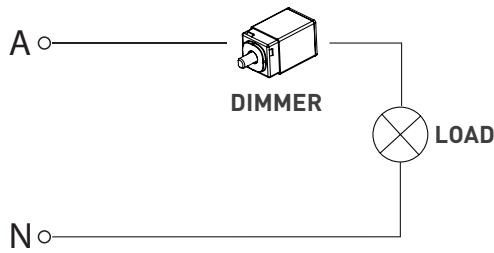

### Dimmer Knob and Push Switch Operation:

1. Push knob to turn ON or OFF the lamp.
2. Push and hold the knob to dim the lamp.
3. Turn the knob clockwise to increase brightness.
4. Turn the knob anticlockwise to decrease brightness.

### Step 1

Correctly wire the dimmer to the circuit

- This LED dimmer is designed for one-way or two-way operation.
- Two or more dimmers cannot be connected in parallel to control the same load from two different locations.
- Dimmer mechanism wiring is not polarity sensitive.

### Step 2

Snap a suitable switch fitting to the dimmer module.

### Step 3

Insert the unit to a wall cut-out or wall box and secure using fastening screws or bolts.

### Step 4

Snap to top plate onto the fixed unit and attach the rotary module.

### Setting the minimum Brightness Level:

1. Power on for 10 seconds.
2. Short press for 4x.
3. Long press (hold for more than 3 seconds) twice to reset the minimum level.

Note: Each step must be performed within 15 seconds. Else, it will time out and exit the program without saving.